



## KUEBLER - MAGNET SENSOR LI50 WITH MAGNETIC TAPE B2

SERIE 8.LI50



- Resolution up to 0.005 mm
- Contactless measuring technology
- Status LED
- IP67 Impervious to chips, oil, water, etc.



### PRODUCT DESCRIPTION

Linear sensor used to measure linear movements with high accuracy, for example in woodworking machines, lathes, material handling, overhead cranes etc. The sensor is almost entirely non-sensitive to chips, oil, dust and water and can thus be used in troublesome environments, it is sealed and has no moving parts. This sensor is fitted to read a magnetic tape with a self-adhesive underside. This sensor is available with different resolutions, and if the recipient (counter/PLC) has a multiplication function, a resolution of 5  $\mu\text{m}$  can be achieved. See electrical data (Resolution, Accuracy) for more information. Magnetic tape B2 has a polar distance of 5 mm. For the combination LI50/B2, the distance between sensor and tape must be 0.1 to 2.0 mm (1.0 mm is recommended). For the magnet sensor, the slope must not exceed  $\pm 3^\circ$ , the rotation must not exceed  $\pm 3^\circ$  and the offset must not exceed  $\pm 1$  mm.

The following information is required to select the right combination:

- requirement on accuracy (from 0.1 mm to 0.005 mm)
- the movement's speed (taking into account frequency to subsequent systems and the sensor's max. speed)
- the movement's length (to order the magnetic scale's length = required length of measurement + 1 dm)

Please refer to the images below for ordering information.

Order code sensor head Limes LI50		8.LI50 . X1X1 . 2XXX						
		Type	a	b	c	d	e	f
<b>a</b> Model		<b>c</b> Output circuit / power supply		<b>e</b> Reference signal		Stock types 8.LI50.1111.2050 8.LI50.1111.2250 8.LI50.1121.2050 8.LI50.1121.2250		
1 = IP67, standard 2 = IP68 / IP69k and humidity tested acc. to EN 60068-3-38, EN 60068-3-78		1 = RS422 / 4.8 ... 26 V DC 2 = Push-pull / 4.8 ... 30 V DC		2 = index periodic				
<b>b</b> Pulse edge interval		<b>d</b> Type of connection		<b>f</b> Code (resolution) <sup>1)</sup>				
1 = standard		1 = cable, 2 m [6.56'] PUR		050 = 25 µm 250 = 5 µm				

Order code magnetic band Limes B2		8.B2 . 10 . 010 . XXXX				
		Type	a		b	
<b>a</b> Width		<b>b</b> Length		Optional on request		Stock types 8.B2.10.010.0020
10 = 10 mm		0010 = 1 m 0020 = 2 m 0040 = 4 m 0050 = 5 m		- other lengths up to 70 m		
		0100 = 10 m 0200 = 20 m				

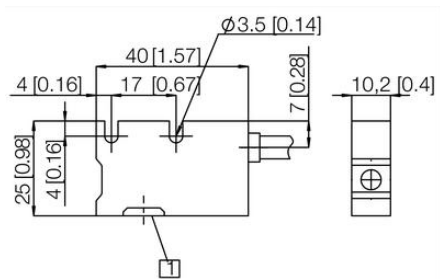

1 mätområde